

All dimensions are imperial unless stated.

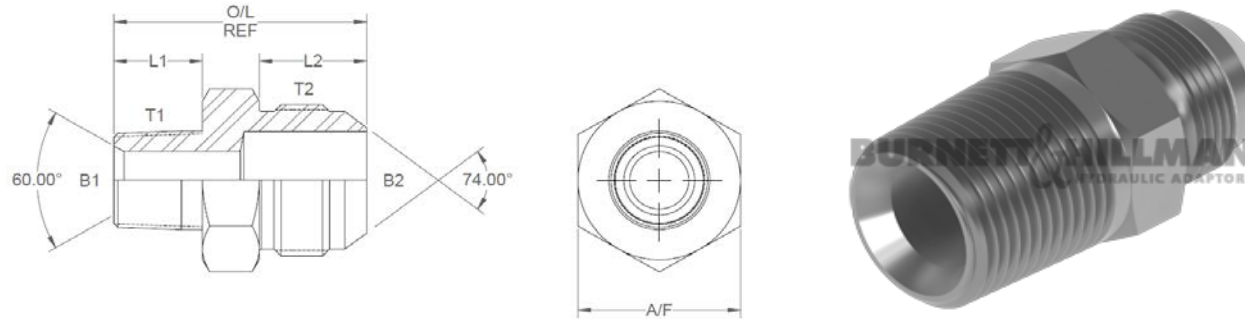

	T1	T2	B1	B2	L1	L2	O/L	A/F
00772	1/8	3/8	0.188	0.125	0.38	0.479	1.06	0.437
00720	1/8	7/16	0.172		0.38	0.55	1.22	0.5
00721	1/8	1/2	0.188	0.234	0.38	0.55	1.22	0.562
00722	1/8	9/16	0.188	0.297	0.38	0.556	1.22	0.625
00723	1/8	3/4	0.188	0.391	0.38	0.657	1.32	0.812
00742	1/4	3/8	0.25	0.125	0.56	0.479	1.31	0.562
00724	1/4	7/16	0.25	0.172	0.56	0.55	1.42	0.562
00725	1/4	1/2	0.25	0.234	0.56	0.55	1.42	0.562
00726	1/4	9/16	0.25	0.297	0.56	0.556	1.43	0.625
00727	1/4	3/4	0.25	0.391	0.56	0.657	1.43	0.812
00728	1/4	7/8	0.25	0.484	0.56	0.758	1.69	1
00743	1/4	1-1/16	0.25	0.609	0.56	0.864	1.85	1.125
00744	1/4	1-5/16	0.25	0.844	0.56	0.911	1.95	1.375
00729	3/8	7/16	0.375	0.172	0.56	0.55	1.42	0.687
00730	3/8	1/2	0.375	0.234	0.56	0.55	1.42	0.687
00731	3/8	9/16	0.297		0.56	0.556	1.43	0.687
00732	3/8	3/4	0.375	0.391	0.56	0.657	1.53	0.812
00733	3/8	7/8	0.375	0.484	0.56	0.758	1.79	1
00734	3/8	1-1/16	0.375	0.609	0.56	0.864	1.85	1.125
00775	3/8	1-5/16	0.375	0.844	0.56	0.911	1.95	1.375

DESIGN DETAILS AND SPECIFICATIONS SUBJECT TO CHANGE WITHOUT PRIOR NOTICE - Whilst every effort has been made to ensure the accuracy of the information supplied herein, Burnett & Hillman cannot be held responsible for any errors or omissions (E&OE)

All dimensions are imperial unless stated.

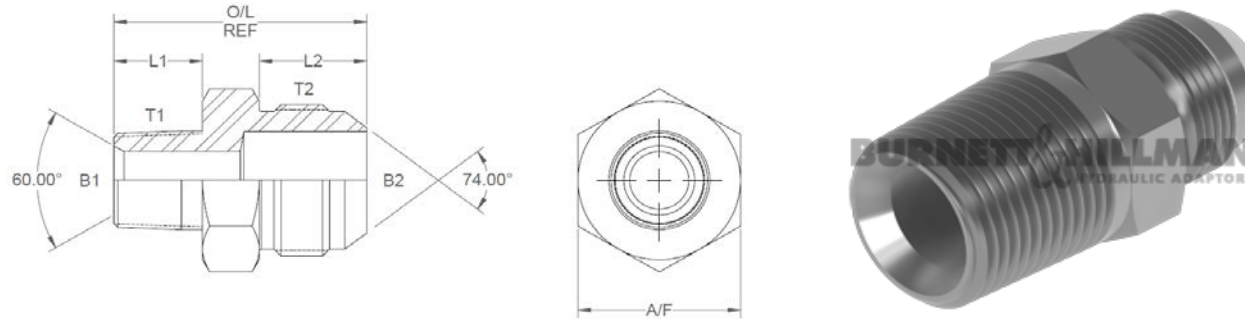

	T1	T2	B1	B2	L1	L2	O/L	A/F
00735	1/2	7/16	0.5	0.172	0.75	0.55	1.68	22mm
00736	1/2	1/2	0.5	0.234	0.75	0.55	1.68	22mm
00737	1/2	9/16	0.5	0.297	0.75	0.556	1.69	22mm
00738	1/2	3/4	0.391		0.75	0.657	1.79	22mm
00739	1/2	7/8	0.484		0.75	0.758	1.89	1
00740	1/2	1-1/16	0.5	0.609	0.75	0.864	1.95	1.125
00741	1/2	1-5/16	0.5	0.844	0.75	0.911	2.15	1.375
00745	3/4	7/16	0.687	0.172	0.75	0.55	1.75	27mm
00746	3/4	9/16	0.687	0.297	0.75	0.556	1.75	27mm
00747	3/4	3/4	0.687	0.391	0.75	0.657	1.85	27mm
00748	3/4	7/8	0.687	0.484	0.75	0.758	1.96	27mm
00749	3/4	1.-1/16	0.609		0.75	0.864	2.06	1.125
00750	3/4	1-5/16	0.609	0.844	0.75	0.911	2.15	1.375
00771	3/4	1-5/8	0.687	1.078	0.75	0.958	2.36	46mm
00767	1	3/4	0.843	0.391	0.97	0.657	2.05	1.375
00768	1	7/8	0.843	0.484	0.97	0.758	2.15	1.375
00751	1	1-1/16	0.843	0.609	0.97	0.864	2.25	1.375
00752	1	1-5/16	0.844		0.97	0.911	2.3	1.375
00753	1	1-5/8	0.844	1.078	0.97	0.958	2.4	1.75
00754	1	1-7/8	0.844	1.312	0.97	1.083	2.51	50mm

DESIGN DETAILS AND SPECIFICATIONS SUBJECT TO CHANGE WITHOUT PRIOR NOTICE - Whilst every effort has been made to ensure the accuracy of the information supplied herein, Burnett & Hillman cannot be held responsible for any errors or omissions (E&OE)

All dimensions are imperial unless stated.

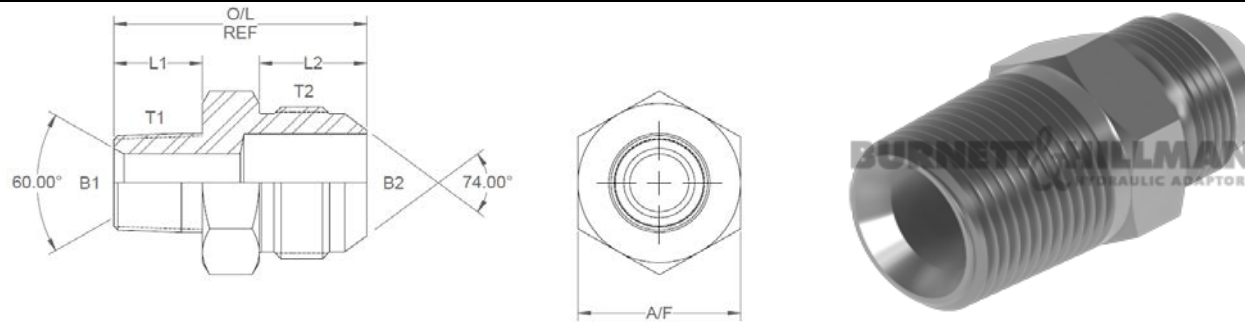

	T1	T2	B1	B2	L1	L2	O/L	A/F
00756	1-1/4	1-1/16	1.203	0.609	0.97	0.864	2.35	1.75
00757	1-1/4	1-5/16	1.203	0.844	0.97	0.911	2.4	1.75
00758	1-1/4	1.5/8	1.203	1.078	0.97	0.958	2.45	1.75
00759	1-1/4	1-7/8	1.203	1.312	0.97	1.083	2.613	50mm
00760	1-1/4	2-1/2	1.203	1.781	0.97	1.333	2.86	65mm
00761	1-1/2	1-1/16	1.312	0.609	1	0.864	2.46	50mm
00762	1-1/2	1-5/16	1.312	0.844	1	0.911	2.51	50mm
00763	1-1/2	1-5/8	1.312	1.078	1	0.958	2.55	50mm
00764	1-1/2	1-7/8	1.312	0	1	1.083	2.68	50mm
00765	1-1/2	2-1/2	1.312	1.781	1	1.333	2.95	65mm
00770	2	1-5/8	1.812	1.078	1.03	0.958	2.73	65mm
00769	2	1-7/8	1.812	1.312	1.03	1.083	2.86	65mm
00766	2	2-1/2	1.781	0	1.03	1.333	3.11	65mm
00755	2-1/2	3	2.25	0	1.52	1.575	3.882	3.25

A/F dimensions are imperial unless stated.

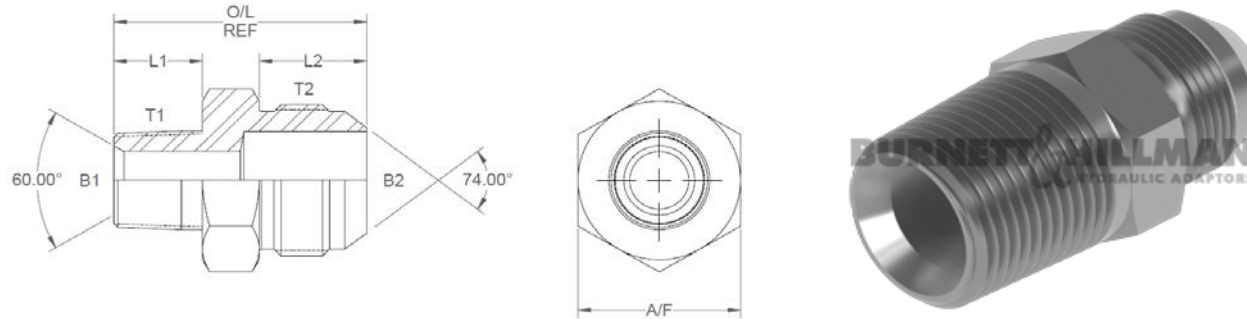

	T1	T2	B1	B2	L1	L2	O/L	A/F
00772	1/8	3/8	4.78	3.18	9.65	12.17	26.92	0.437
00720	1/8	7/16	4.37		9.65	13.97	30.99	0.5
00721	1/8	1/2	4.78	5.94	9.65	13.97	30.99	0.562
00722	1/8	9/16	4.78	7.54	9.65	14.12	30.99	0.625
00723	1/8	3/4	4.78	9.93	9.65	16.69	33.53	0.812
00742	1/4	3/8	6.35	3.18	14.22	12.17	33.27	0.562
00724	1/4	7/16	6.35	4.37	14.22	13.97	36.07	0.562
00725	1/4	1/2	6.35	5.94	14.22	13.97	36.07	0.562
00726	1/4	9/16	6.35	7.54	14.22	14.12	36.32	0.625
00727	1/4	3/4	6.35	9.93	14.22	16.69	36.32	0.812
00728	1/4	7/8	6.35	12.29	14.22	19.25	42.93	1
00743	1/4	1-1/16	6.35	15.47	14.22	21.95	46.99	1.125
00744	1/4	1-5/16	6.35	21.44	14.22	23.14	49.53	1.375
00729	3/8	7/16	9.53	4.37	14.22	13.97	36.07	0.687
00730	3/8	1/2	9.53	5.94	14.22	13.97	36.07	0.687
00731	3/8	9/16	7.54		14.22	14.12	36.32	0.687
00732	3/8	3/4	9.53	9.93	14.22	16.69	38.86	0.812
00733	3/8	7/8	9.53	12.29	14.22	19.25	45.47	1
00734	3/8	1-1/16	9.53	15.47	14.22	21.95	46.99	1.125
00775	3/8	1-5/16	9.53	21.44	14.22	23.14	49.53	1.375

DESIGN DETAILS AND SPECIFICATIONS SUBJECT TO CHANGE WITHOUT PRIOR NOTICE - Whilst every effort has been made to ensure the accuracy of the information supplied herein, Burnett & Hillman cannot be held responsible for any errors or omissions (E&OE)

A/F dimensions are imperial unless stated.

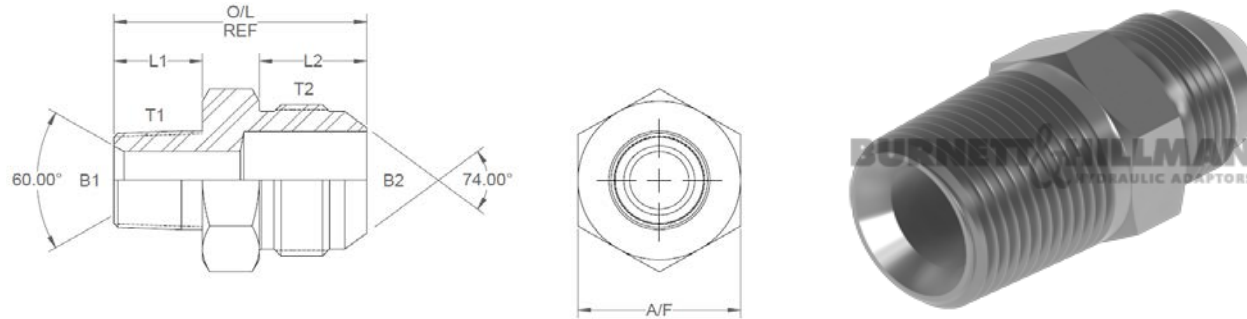

	T1	T2	B1	B2	L1	L2	O/L	A/F
00735	1/2	7/16	12.7	4.37	19.05	13.97	42.67	22mm
00736	1/2	1/2	12.7	5.94	19.05	13.97	42.67	22mm
00737	1/2	9/16	12.7	7.54	19.05	14.12	42.93	22mm
00738	1/2	3/4	9.93		19.05	16.69	45.47	22mm
00739	1/2	7/8	12.29		19.05	19.25	48.01	1
00740	1/2	1-1/16	12.7	15.47	19.05	21.95	49.53	1.125
00741	1/2	1-5/16	12.70	21.44	19.05	23.14	54.61	1.375
00745	3/4	7/16	17.45	4.37	19.05	13.97	44.45	27mm
00746	3/4	9/16	17.45	7.54	19.05	14.12	44.45	27mm
00747	3/4	3/4	17.45	9.93	19.05	16.69	46.99	27mm
00748	3/4	7/8	17.45	12.29	19.05	19.25	49.78	27mm
00749	3/4	1.-1/16	15.47		19.05	21.95	52.32	1.125
00750	3/4	1-5/16	15.47	21.44	19.05	23.14	54.61	1.375
00771	3/4	1-5/8	17.45	27.38	19.05	24.33	59.94	46mm
00767	1	3/4	21.41	9.93	24.64	16.69	52.07	1.375
00768	1	7/8	21.41	12.29	24.64	19.25	54.61	1.375
00751	1	1-1/16	21.41	15.47	24.64	21.95	57.15	1.375
00752	1	1-5/16	21.44		24.64	23.14	58.42	1.375
00753	1	1-5/8	21.44	27.38	24.64	24.33	60.96	1.75
00754	1	1-7/8	21.44	33.32	24.64	27.51	63.75	50mm

DESIGN DETAILS AND SPECIFICATIONS SUBJECT TO CHANGE WITHOUT PRIOR NOTICE - Whilst every effort has been made to ensure the accuracy of the information supplied herein, Burnett & Hillman cannot be held responsible for any errors or omissions (E&OE)

A/F dimensions are imperial unless stated.

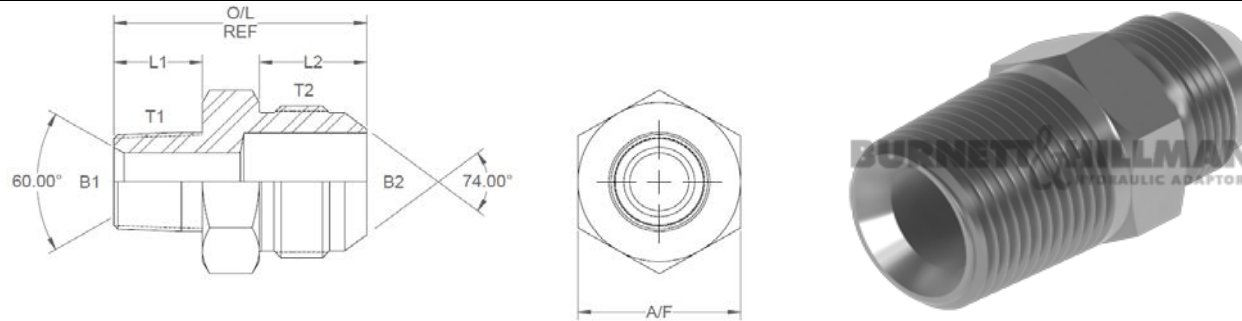

	T1	T2	B1	B2	L1	L2	O/L	A/F
00756	1-1/4	1-1/16	30.56	15.47	0.97	0.864	59.69	1.75
00757	1-1/4	1-5/16	30.56	21.44	0.97	0.911	60.96	1.75
00758	1-1/4	1.5/8	30.56	27.38	0.97	0.958	62.23	1.75
00759	1-1/4	1-7/8	30.56	33.32	0.97	1.083	66.37	50mm
00760	1-1/4	2-1/2	30.56	45.24	0.97	1.333	72.64	65mm
00761	1-1/2	1-1/16	33.32	15.47	1	0.864	62.48	50mm
00762	1-1/2	1-5/16	33.32	21.44	1	0.911	63.75	50mm
00763	1-1/2	1-5/8	33.32	27.38	1	0.958	64.77	50mm
00764	1-1/2	1-7/8	33.32		1	1.083	68.07	50mm
00765	1-1/2	2-1/2	33.32	45.24	1	1.333	74.93	65mm
00770	2	1-5/8	46.02	27.38	1.03	0.958	69.34	65mm
00769	2	1-7/8	46.02	33.32	1.03	1.083	72.64	65mm
00766	2	2-1/2	45.24		1.03	1.333	78.99	65mm
00755	2-1/2	3	57.15		1.52	1.575	98.60	3.25