

All dimensions are imperial unless stated.

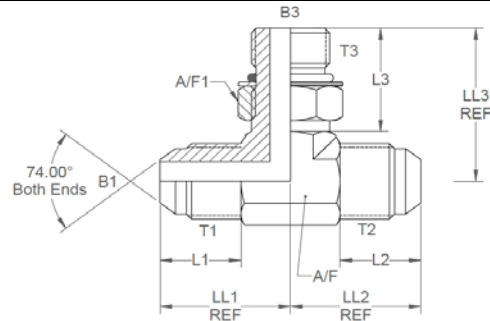

	T1	T2	T3	B1	B3	L1	L2	L3	LL1	LL2	LL3	A/F	A/F1
10715-04-04-04	7/16	7/16	7/16	0.172	0.172	0.535	0.535	0.807	0.89	0.89	1.03	0.438	0.562
10715-05-05-05	1/2	1/2	1/2	0.234	0.234	0.535	0.535	0.881	0.95	0.95	1.13	0.562	0.625
10715-06-06-06	9/16	9/16	9/16	0.297	0.297	0.541	0.541	0.881	1.06	1.06	1.25	0.562	0.687
10715-08-08-08	3/4	3/4	3/4	0.391	0.391	0.642	0.642	1.027	1.25	1.25	1.45	0.75	0.875
10715-10-10-10	7/8	7/8	7/8	0.484	0.484	0.743	0.743	1.188	1.45	1.45	1.7	0.875	1
10715-12-12-12	1-1/16	1-1/16	1-1/16	0.609	0.609	0.849	0.849	1.33	1.66	1.66	1.94	1.062	1.25
10715-14-14-14	1-3/16	1-3/16	1-3/16	0	0	0	0	0	0	0	0	0	0
10715-16-16-16	1-5/16	1-5/16	1-5/16	0.844	0.844	0.896	0.896	1.362	1.81	1.81	2.05	1.312	1.5
10715-20-20-20	1-5/8	1-5/8	1-5/8	1.078	1.078	0.943	0.943	1.362	2.06	2.06	2.25	1.625	1.875
10715-24-24-24	1-7/8	1-7/8	1-7/8	0	0	0	0	0	0	0	0	0	0

A/F dimensions are imperial unless stated.

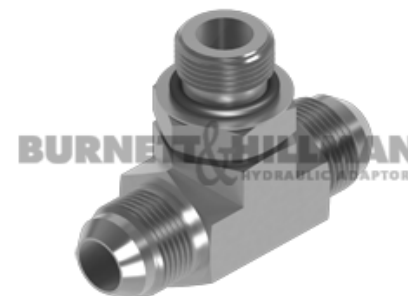
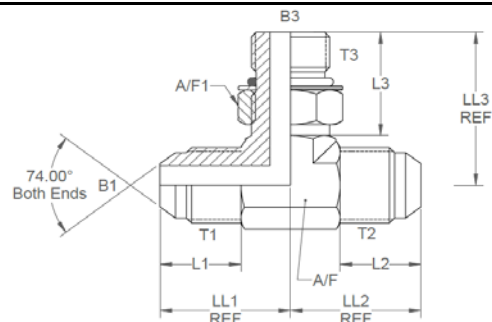

	T1	T2	T3	B1	B3	L1	L2	L3	LL1	LL2	LL3	A/F	A/F1
10715-04-04-04	7/16	7/16	7/16	4.37	4.37	13.59	13.59	20.5	22.61	22.61	26.16	0.438	0.562
10715-05-05-05	1/2	1/2	1/2	5.94	5.94	13.59	13.59	22.38	24.13	24.13	28.7	0.562	0.625
10715-06-06-06	9/16	9/16	9/16	7.54	7.54	13.74	13.74	22.38	26.92	26.92	31.75	0.562	0.687
10715-08-08-08	3/4	3/4	3/4	9.93	9.93	16.31	16.31	26.09	31.75	31.75	36.83	0.75	0.875
10715-10-10-10	7/8	7/8	7/8	12.29	12.29	18.87	18.87	30.18	36.83	36.83	43.18	0.875	1
10715-12-12-12	1-1/16	1-1/16	1-1/16	15.47	15.47	21.56	21.56	33.78	42.16	42.16	49.28	1.062	1.25
10715-14-14-14	1-3/16	1-3/16	1-3/16	0	0	0	0	0	0	0	0	0	0
10715-16-16-16	1-5/16	1-5/16	1-5/16	21.44	21.44	22.76	22.76	34.59	45.97	45.97	52.07	1.312	1.5
10715-20-20-20	1-5/8	1-5/8	1-5/8	27.38	27.38	23.95	23.95	34.59	52.32	52.32	57.15	1.625	1.875
10715-24-24-24	1-7/8	1-7/8	1-7/8	0	0	0	0	0	0	0	0	0	0